



MILK FROTHER

HOT & COLD

User Manual



*Please refer to the warranty section for terms of your extended guarantee

READING AND STORING THE USER MANUAL



Before using this product, please read through this manual carefully paying particular attention to the safety instructions. Failure to do so may result in personal injury or damage to the product.

Carefully save this instruction manual for future reference. Ensure the user manual is included when passing the product on to any third parties.

IMPORTANT SAFETY INSTRUCTIONS FOR PROPER USE

When using electrical appliances, basic safety precautions should always be followed.

Only use the product as described in this user manual. Any other use is considered improper and may result in damage to property or persons. The manufacturer or vendor cannot be held liable for damages or injury incurred through improper or incorrect use.

- **Read and familiarise yourself with all operating instructions before using this Milk Frother.**
- Before plugging your kettle into the mains, visually check that the kettle is intact and has not suffered any transit damage.
- Check that the voltage indicated on the data plate corresponds with that of the local network before connecting the appliance to the mains power supply.
- This kettle is only to be used with the stand provided.
- Close supervision is required when using this appliance near children.
- Never leave this appliance within reach of children.
- This appliance can be used by children aged from 8 years and above if they have been given supervision or instruction concerning use of the appliance in a safe way and if they understand the hazards involved. Cleaning and user maintenance shall not be made by children unless they are older than 8 and supervised. Keep the appliance and its cord out of reach of children aged less than 8 years. This appliance can be used by persons with reduced physical, sensory or mental capabilities or lack of

experience and knowledge if they have been given supervision or instruction concerning use of the appliance in a safe way and understand the hazards involved.

Children shall not play with the appliance.

- **DO NOT** leave the appliance unattended during use.
- **DO NOT** leave the appliance unattended whilst connected to the mains supply.
- Always use this appliance on a solid, level, non-flammable surface.
- **DO NOT** use this appliance outdoors.
- It is imperative to unplug the power cord after the appliance has been used, before it is cleaned and whilst being repaired.
- If the supply cord is damaged, it must be replaced by the manufacturer, service agent or similarly qualified person in order to avoid hazard.
- Repairs to electrical appliances should only be performed by qualified personnel. Improper repairs may place user at serious risk.
- **DO NOT** operate this appliance with a damaged plug or cord, after a malfunction or after being dropped or damaged in any way.
- Regular, periodic checks should be carried out on the mains cable to ensure no damage is evident. Should there be any signs of damage the appliance should not be used.
- **DO NOT** allow the mains cable to hang over sharp edges or come in contact with hot surfaces.
- **DO NOT** run the mains cable under carpets, rugs, etc.
- Allow the unit to cool before storage.
- Never place the appliance near to flammable material or high-pressure containers.
- This appliance is intended for household use only and should not be used for industrial purposes.
- **DO NOT** use any accessories or attachments with this appliance other than those supplied or recommended by

supplier.

- **DO NOT** immerse the appliance, base or its cord in water or any other liquids.
- **DO NOT** use this appliance for anything other than its intended use.
- **DO NOT** push objects into any openings as damage to the appliance and/or electric shock may occur.
- Ensure appliance is situated in an open area, do not allow it to come in contact with cupboards, curtains, wall coverings, clothing or other flammable materials.
- Unplug after each use. Grasp the plug, not the cord.
- **DO NOT** cover this appliance.
- Never place this appliance on an electric, gas, or any other type of hob.
- **WARNING: Do not open lid whilst the water is boiling.**
- Never fill the Milk Frother more than its capacity – ensure the water level is between the min and max marks. If the Milk Frother is overfilled, boiling water may be ejected.
- Always close the lid during use and do not open the lid whilst the water is boiling.
- **CAUTION: The outside surface of the Milk Frother will get hot during use.**
- Ensure the Milk Frother has switched off before removing it from the base.

THIS APPLIANCE MUST BE EARTHED

Explanation of Symbols

The following warning symbols or words are used in this instruction manual:



Products labelled with UK Conformity Assessment identifies products conforming to UK statutory requirements.



Products labelled with this symbol conform to applicable provisions of the European Economic Area.

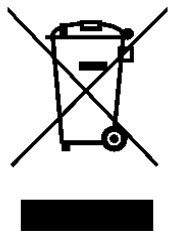

You should now recycle your waste electrical goods and in doing so help the environment. This symbol means waste electrical products at the end of their useful life should not be disposed of with normal household waste and sent to landfill. Please ensure it is taken to a suitable facility for disposal. Check with your Local Authority or retailer for recycling advice or visit www.recycle-more.co.uk, enter your postcode to find out your nearest recycling site.



This symbol provides useful additional information on the use of this product.



This symbol indicates that the supply uses an alternating current mains supply.



This designates a hazard with moderate risk, which may result in severe injury if not adhered to.

Description of Parts

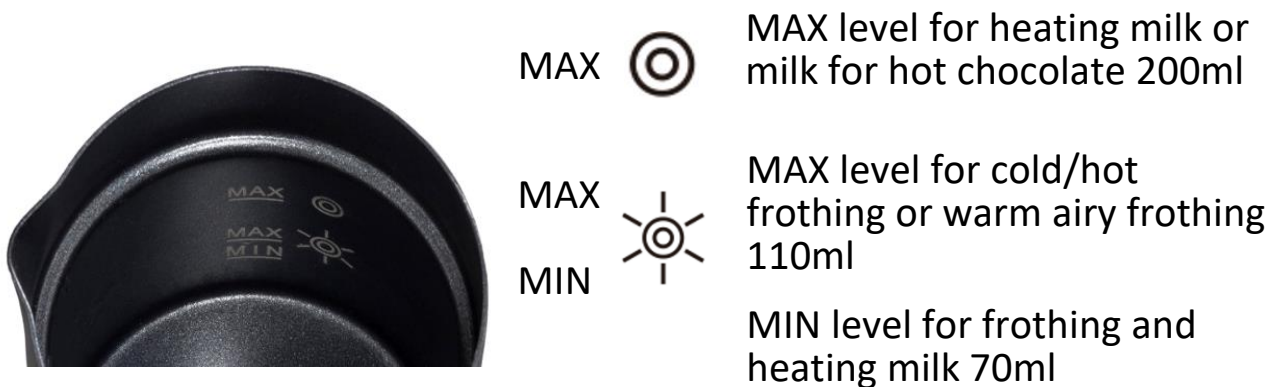

Before First Use of Your Milk Frother

Remove all packing materials and discard responsibly.

Before using the Milk Frother for the first time, wipe with a damp soft cloth and dry thoroughly.

Using Your Milk Frother

Touch Control Button

Press the **Touch control button (6)** for:

- Hot milk froth for a Cappuccino - press once and the **LED Indicator (7)** will illuminate red.
- Hot Milk froth for a Latte - press twice and the **LED Indicator (7)** will illuminate purple.
- Heating milk without frothing - press three times and the **LED Indicator (7)** will illuminate yellow.
- To froth milk without heat – press four times and the **LED Indicator (7)** will illuminate blue.

Programme	Button Operation	LED Light	ML's	Time	Temperature
Hot milk froth-Cappuccino	Press once	Red	110ml	120 seconds	50-60°C
Hot milk froth - Latte	Press twice	Purple	110ml	100 seconds	50-60°C
Heating milk without frothing	Press three times	Yellow	220ml	120 seconds	50-60°C
Frothing without heat	Press four times	Blue	110ml	120 seconds	0°C

Choosing an option

1. Place the **Whisk (2)** onto the spindle inside the **Milk Jug (3)**.
2. Pour the milk into the **Milk Jug (3)** to the **MAX Fill Line** ☉ or **MAX Fill Line** ☼ (1). **Do not exceed the MAX Fill Lines.**

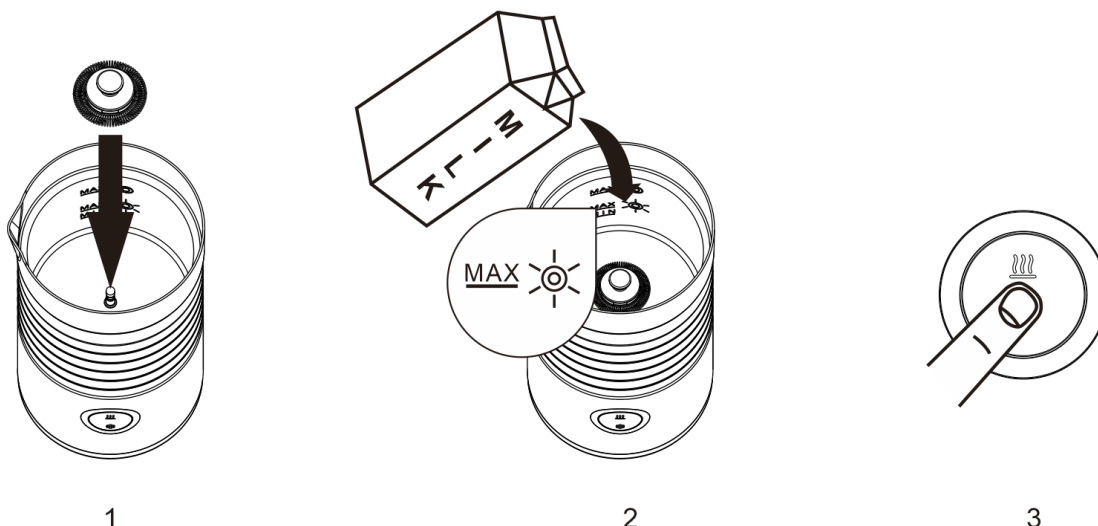

3. Place the **Lid (5)** onto the **Milk Jug (3)**.
4. Press the **Touch Control Button (6)** according to one of the 4 options above. The **LED Indicator (7)** will illuminate to the colour selected and the Milk Frother will start to operate.
5. After approximately 100 - 120 seconds (depending on choice) the Milk Frother will stop automatically, the **LED Indicator (7)** will flash for 10 seconds and power off. The process can be stopped at anytime by pressing **Touch Control Button (6)**.

Hints and Tips

Use refrigerated whole milk for best result. Non-dairy milk doesn't froth as well as dairy milk since the protein content is lower than dairy milk, so it barely froths. For non-dairy milk lovers, we recommend a Barista style non-dairy milk which should help with the Milk Frother for plant based milk. Froth result cannot be guaranteed for any other non-barista style plant milk.

Milk heats to approximately 50-65°C. This is the optimal temperature, as it ensures the flavour of the coffee is not impaired. Over-heating will destroy milk nutrients.

Do not fill the milk amount past the MAX level mark inside of the jug or it will overflow.

The key factor in achieving a good froth is using fresh cold milk. Use milk that has been taken directly from the refrigerator and start frothing immediately.

Cleaning

- Remove the mains plug and allow the appliance to cool down after use.
- Always remove the jug from the power base before cleaning.
- Clean the power base and cord with a soft cloth only.
- The Milk Frother is not dishwasher-safe. Rinse the **Milk Jug (3)** in warm soapy water and dry thoroughly.
- **Do not** submerge the bottom of the **Milk Jug (3)** into water.

Non-Rewireable Mains Plug

If your appliance is supplied with a non-rewireable plug fitted to the mains lead and should the fuse need replacing, you must use an ASTA approved one (conforming to BS 1362 of the same rating). Never use a plug with the fuse cover missing. If in doubt consult a qualified electrician.

If you need to remove the plug – DISCONNECT FROM THE MAINS – and then cut it off the mains lead and immediately dispose of it safely. Never attempt to reuse the plug or insert it into a socket outlet as there is a danger of electric shock.

Technical Specification

Model Number	SDA2696
Rated Voltage	220-240V AC ~ 50/60Hz
Rated Power	500-600W
Protection Class	I (This appliance must be Earthed)

Recycling Information

Disposal of the Packaging

Dispose of paper and cardboard in appropriate paper re-cycling facilities.
Dispose of recyclable plastics in appropriate plastic re-cycling facilities.
Dispose of non-recyclable plastics in the appropriate plastics collection service.

Disposal of the Product

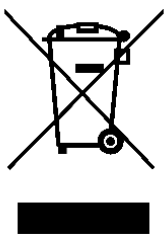

You should now recycle your waste electrical goods and in doing so help the environment. This symbol means waste electrical products at the end of their useful life should not be disposed of with normal household waste and not sent to landfill. Please ensure it is taken to a suitable facility for disposal. Check with your Local Authority or retailer for recycling advice or visit www.recycle-more.co.uk, enter your postcode to find out your nearest recycling site.

Customer Support

Should you require any product information, replacement parts or accessories, please contact our customer care team on 0161 831 7879 (8.30am-4.30pm Monday to Thursday, 8.00am-4.00pm Friday) and select option 3 or by contacting us via email: help@daewooelectricals.com.

- Replacement parts and accessories are guaranteed for 1 year from the date of purchase.
- It is important to note that your warranty becomes invalid should non Daewoo parts or accessories be used with this appliance.

UK
CA

CE

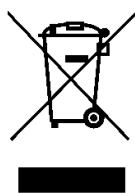



DAEWOO®

WARRANTY

Thank you for purchasing your Daewoo product.

As part of our commitment to quality, we are offering you an extra 2 years warranty in addition to your 1 year guarantee

Your Daewoo product is guaranteed for 1 year from the date of original purchase, with proof of purchase or receipt. If any defect should occur due to faulty workmanship or material, your faulty product should be returned to the place of purchase, replacement or refund is at the discretion of the retailer.

The guarantee is subject to the following provisions:

- The product must be correctly installed and operated in accordance with the requirements contained in the instruction manual.
- The product must be used solely for domestic purposes.
- It does not cover general wear and tear, damage, misuse or any consumable parts.
- The guarantee will be rendered invalid if the product is re-sold or has been damaged through inexpert repair.
- The guarantee is only valid within the UK and Eire.

Your standard 1 year guarantee will only be extended to the maximum available for your individual product upon registration. (Note: products must be registered individually and covers the main body and housing). If you do not register your product within 28 days of the original purchase date, your product will only be guaranteed for 1 year.

To validate your extended 2 year warranty* please register your purchase online within 28 days of the original purchase date by registering at:

<https://help.daewooelectricals.com>

or

[Contact Us \(daewooelectricals.com\)](https://daewooelectricals.com)

*Your extended warranty is only valid with proof of purchase receipt and subject to the conditions outlined above.

Daewoo is a registered trademark.
Produced and imported under licence by
Eurosonic Group Limited
Brightgate House
1 Brightgate Way
Manchester M32 0TB UK
EU Rep: EuroSonic Magppie (ESM) Ltd. Ireland D05 X006
www.esgltd.com