



Please refer to the warranty section for terms of your extended guarantee



ELECTRIC CAN OPENER

With knife sharpener & bottle opener

READING AND STORING THE USER MANUAL



Before using this product, please read through this manual carefully paying particular attention to the safety instructions. Failure to do so may result in personal injury or damage to the product.

Carefully save this instruction manual for future reference. Ensure the user manual is included when passing the product on to any third parties.

IMPORTANT SAFETY INSTRUCTIONS FOR PROPER USE

When using electrical appliances, safety precautions should always be followed.

Only use the product as described in this user manual. Any other use is considered improper and may result in damage to property or persons. The manufacturer or vendor cannot be held liable for damages or injury incurred through improper or incorrect use.

- **Read and familiarise yourself with all operating instructions before using this Electric Can Opener.**
- Before plugging your unit into the mains supply, visually check that it is intact and has not suffered any transit damage.
- **DO NOT** use this product with a programmer, timer, separate remote-control system or any other device.
- Check that the voltage indicated on the data plate corresponds with that of the local network before connecting the appliance to the mains power supply.
- **DO NOT** immerse this appliance in water or any other liquids.
- Close supervision is required when using this appliance near children.
- Never leave this appliance within reach of children.
- This appliance shall not be used by children.
- Keep the appliance and its cable out of the reach of children.
- Appliances can be used by persons with reduced physical,

sensory or mental capabilities or lack of experience and knowledge if they have been given supervision or instruction concerning use of the appliance in a safe way and understand the hazards involved.

- Children shall not play with the appliance.
- Cleaning and user maintenance shall not be made by children.
- **DO NOT** leave the appliance unattended during use.
- **DO NOT** leave the appliance unattended whilst connected to the mains supply.
- Always use this appliance on a solid, level, non-flammable surface.
- Protect the unit from moisture whilst using this appliance outdoors.
- Repairs to electrical appliances should only be performed by qualified personnel. Improper repairs may place user at serious risk.
- It is imperative to unplug the mains cable after the appliance has been used, before it is cleaned and whilst being repaired.
- Regular, periodic checks should be carried out on the mains cable to ensure no damage is evident. Should there be any signs of damage the appliance should not be used.
- **DO NOT** operate this appliance with a damaged plug or mains cable, after a malfunction or after being dropped or damaged in any way.
- **DO NOT** allow the mains cable to hang over sharp edges or come in contact with hot surfaces.
- **DO NOT** use this appliance for anything other than its intended use.
- **DO NOT** push objects into any openings as damage to the appliance and/or electric shock may occur.

- This appliance is intended for household use only and should not be used for industrial or commercial purposes.
- Switch off the appliance and disconnect from the mains supply before approaching parts that move in use.

Explanation of Symbols

The following warning symbols or words are used in this instruction manual:



Products labelled with UK Conformity Assessment identifies products conforming to UK statutory requirements.



Products labelled with this symbol conform to applicable provisions of the European Economic Area.



This Class 2 symbol indicates that the product is electrically double insulated and does not require an earth connection.

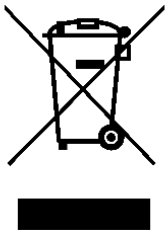

You should now recycle your waste electrical goods and in doing so help the environment. This symbol means waste electrical products at the end of their useful life should not be disposed of with normal household waste and not sent to land fill. Please ensure it is taken to a suitable facility for disposal. Check with your Local Authority or retailer for recycling advice or visit www.recycle-more.co.uk, enter your postcode to find out your nearest recycling site.



This symbol provides useful additional information on the use of this product.



This designates a hazard with moderate risk, which may result in severe injury if not adhered to.

Description of parts

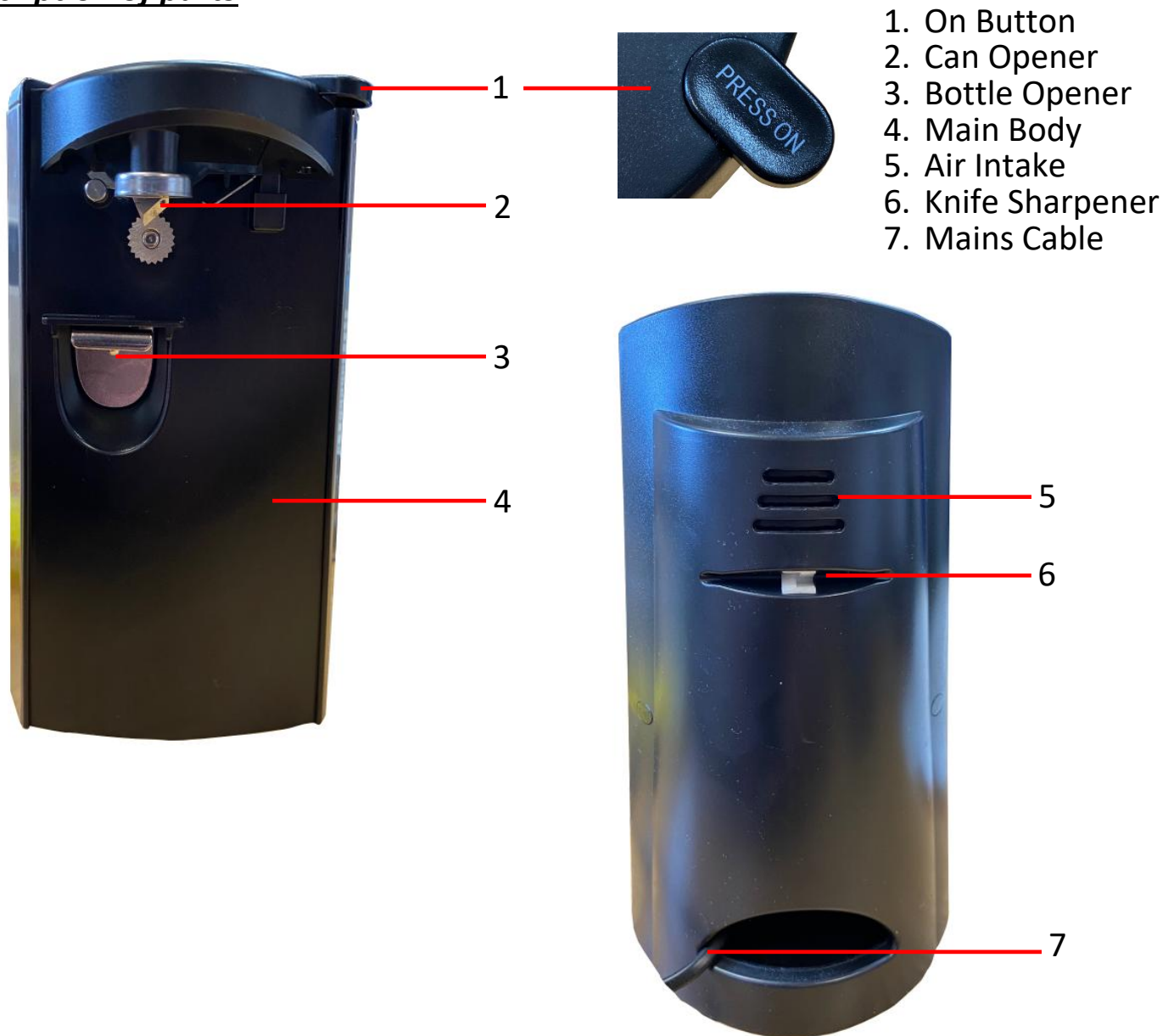

Before the First Use of Your Electric Can Opener

- Remove all packing materials and discard responsibly.
- Wipe the **Main Body** (4) with a clean, soft, damp cloth.
- Do not use harsh or abrasive cleaners.
- Do not clean any part of your Electric Can Opener in a dishwasher.

⚠ WARNING! Take care when cleaning the **Can Opener** (2) as the cutting edges are sharp.

Assembling your Electric Can Opener

To prevent any damage occurring in transit, the Electric Can Opener comes with the cutting head disassembled. Before using for the first time, you will need to follow the below steps;

1. Insert the cutting head into the predrilled hole on the **Main Body** (4).
2. Ensure that the cutting head is firmly in place and then the Can Opener is ready to use.

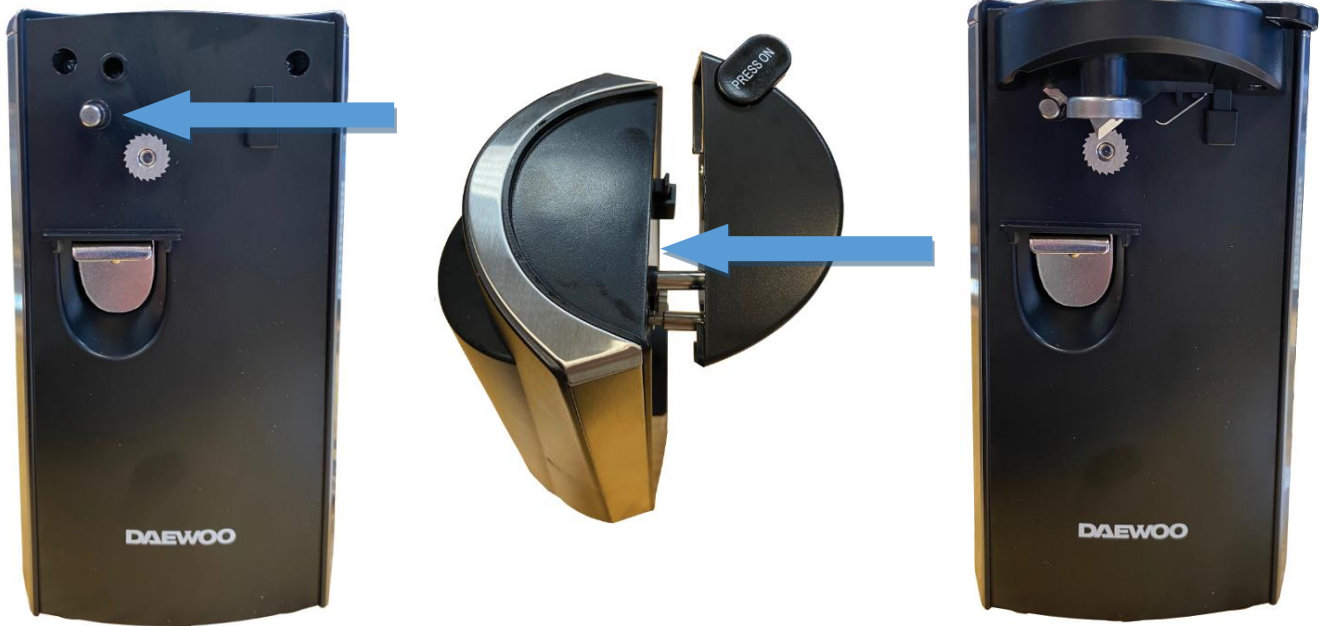

Using the Bottle Opener

The **Bottle Opener** (3) of the Electric Can Opener can be used on its own without the need to be connected to the mains. Place the Electric Can Opener on solid level surface and place the bottle to be opened into the **Bottle Opener** (3). Hold the top of the **Main Body** (4) with one hand and the bottle with other and then press the bottle down until the cap is removed.



Using the Knife Sharpener

The **Knife Sharpener** (6) of the Electric Can Opener can be used on its own without the need to be connected to the mains. Place the Electric Can Opener on solid level surface and place the knife blade to be sharpened into the **Knife Sharpener** (6). Slide the blade towards you to sharpen, until the required sharpness has been achieved.



Using Your Electric Can Opener

1. Place the Electric Can Opener on a solid, level surface.
2. Insert the mains plug into a suitable socket outlet.
3. Lift the hinged **Can Opener (2)** section and insert the can ensuring that the can engages the magnet in the **Can Opener (2)** mechanism.
4. Lower the **Can Opener (2)** onto the can, allowing the cutting blade to pierce the can and then press the **On Button (1)** down to engage operation.
5. When the can is fully open, the body of the can is freely removed, the lid will remain engaged by the magnet on the **Can Opener (2)**.



⚠ WARNING! Take care when removing the opened lid from the **Can Opener (2)** as the cut edges will be sharp.

Troubleshooting

Symptom	Possible Cause	Possible Solution
There is no power from the unit	The fuse in the plug has failed	Check the fuse by substitution.
	The Electric Can Opener is not connected to the mains supply	Check that the appliance is connected to the mains supply.

Care and Maintenance

- Always disconnect the Electric Can Opener from the mains power supply before cleaning.
- Clean the appliance with a clean, soft damp cloth.
- Never clean with harsh or abrasive cleaners.
- Do not submerge the appliance in water or any other liquids.
- Do not clean any part of your Electric Can Opener in a dishwasher.

Technical Specification

Model No.	SDA2313
Rated Voltage	220-240V~ 50Hz
Rated Power	60W
Protection Class	II
ErP	0,00W
This Equipment complies with Annex III of the Commission Regulation (EU) 2023/826	

Non-Rewireable Mains Plug

If your appliance is supplied with a non-rewireable plug fitted to the mains lead and should the fuse need replacing, you must use an ASTA approved one (conforming to BS 1362 of the same rating). Never use a mains plug with the fuse cover missing. If in doubt, consult a qualified electrician.

If you need to remove the plug – **DISCONNECT FROM THE MAINS** – and then cut it off the mains lead and immediately dispose of it safely. Never attempt to reuse the plug or insert it into a socket outlet as there is a danger of electric shock.

Recycling Information

Disposal of the Packaging

Dispose of paper and cardboard in appropriate paper re-cycling facilities.

Dispose of recyclable plastics in appropriate plastic re-cycling facilities.

Dispose of non-recyclable plastics in the appropriate plastics collection service.

Disposal of the Product

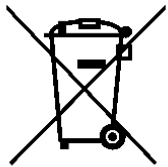

You should now recycle your waste electrical goods and in doing so help the environment. This symbol means waste electrical products at the end of their useful life should not be disposed of with normal household waste and not sent to landfill. Please ensure it is taken to a suitable facility for disposal. Check with your Local Authority or retailer for recycling advice or visit www.recycle-more.co.uk or www.weeireland.ie, enter your postcode to find out your nearest recycling site.

Customer Support

Should you require any product information, replacement parts or accessories, please contact our customer care team on 0161 831 7879 (8.30am-4.30pm Monday to Thursday, 8.00am-4.00pm Friday) and select option 3 or by contacting us via email: help@daewooelectricals.com.

- Replacement parts and accessories are guaranteed for 1 year from the date of purchase.
- It is important to note that your warranty becomes invalid should non Daewoo parts or accessories be used with this appliance.

Notes

Notes





DAEWOO®

WARRANTY

Thank you for purchasing your Daewoo product.

As part of our commitment to quality, we are offering you an extra 2 years warranty in addition to your 1 year guarantee

Your Daewoo product is guaranteed for 1 year from the date of original purchase, with proof of purchase or receipt. If any defect should occur due to faulty workmanship or material, your faulty product should be returned to the place of purchase, replacement or refund is at the discretion of the retailer.

The guarantee is subject to the following provisions:

- The product must be correctly installed and operated in accordance with the requirements contained in the instruction manual.
- The product must be used solely for domestic purposes.
- It does not cover general wear and tear, damage, misuse or any consumable parts.
- The guarantee will be rendered invalid if the product is re-sold or has been damaged through inexpert repair.
- The guarantee is only valid within the UK and Eire.

Your standard 1 year guarantee will only be extended to the maximum available for your individual product upon registration. (Note: products must be registered individually and covers the main body and housing). If you do not register your product within 28 days of the original purchase date, your product will only be guaranteed for 1 year.

To validate your extended 2 year warranty please register your purchase online within 28 days of the original purchase date by registering at:*

<https://help.daewooelectricals.com>

or

[Contact Us \(daewooelectricals.com\)](mailto:Contact Us (daewooelectricals.com))

*Your extended warranty is only valid with proof of purchase receipt and subject to the conditions outlined above.

Daewoo is a registered trademark.
Produced and imported under licence by
Eurosonic Group (ESG) Limited
Brightgate House
1 Brightgate Way
Manchester M32 0TB UK
EU Rep: EuroSonic Magppie (ESM) Ltd. Ireland D05 X006
www.esgltd.com