



*Please refer to the warranty section for terms of your extended guarantee.

HEATED NECK AND BACK PAD



USER MANUAL

READING AND STORING THE USER MANUAL



Before using this product, please read through this manual carefully paying particular attention to the safety instructions. Failure to do so may result in personal injury or damage to the product.

Carefully save this instruction manual for future reference. Ensure the user manual is included when passing the product on to any third parties.

IMPORTANT SAFETY INSTRUCTIONS FOR PROPER USE

When using electrical appliances, basic safety precautions should always be followed.

Only use the product as described in this user manual. Any other use is considered improper and may result in damage to property or persons. The manufacturer or vendor cannot be held liable for damages or injury incurred through improper or incorrect use.

- **Read and familiarise yourself with all operating instructions before using this Heated Pad.**
- Before plugging your unit into the mains, visually check that the unit is intact and has not suffered any transit damage.
- **DO NOT** use this pad folded or rucked.
- **DO NOT** insert pins into this pad.
- This appliance can be used by children aged from 8 years old and above and persons with reduced physical, sensory or mental capabilities or lack of experience and knowledge if they have been given supervision or instruction concerning use of the appliance in a safe way and understand the hazards involved.
- Children shall not play with the appliance.
- Cleaning and user maintenance shall not be made by children without supervision.
- The appliance can be used by children older than 3 years

and younger than 8 years under supervision and with the controller always set to the minimum (1) temperature setting.

- Not to be used by very young children (0-3 years).
- This appliance is not to be used by young children over the age of three unless the controls have been pre-set by a parent or guardian, or unless the child has been adequately instructed on how to operate the controls safely.
- Children under the age of three are not to use this appliance due to their inability to react to overheating.
- If sleeping for long periods of time, use the low heat setting (1) to avoid overheating and discomfort.
- Avoid using the pad with the higher heat settings (3&4) whilst sleeping as this may increase the risk of skin burns and heat stroke.
- Only use the Controller marked on the rating label with this blanket.
- Whilst storing the pad, allow it to fully cool then fold neatly but not tightly or roll loosely avoiding sharp bends in the heating element.
- **DO NOT** crease the appliance by placing other items on top of the pad.
- Examine the appliance frequently for signs of wear or damage. If there are such signs, if the appliance has been misused or does not work return it to the supplier before switching it on again.
- This pad is for domestic use only and is not intended for commercial use or for use in hospitals.
- **DO NOT** use if damp or wet.
- This appliance must not be used by persons insensitive to heat and other very vulnerable persons who are unable to

react to overheating.

- The appliance should not be used on an adjustable bed.
- When in use ensure the pad & mains lead do not get trapped.
- The cable and control unit of the appliance can give rise to risks of entanglement, strangulation, tripping or treading if not correctly arranged. The user shall make sure that excess ties and electric cords shall be arranged in a safe way.
- Arrange the pad so it is not positioned beneath bolsters or pillows.
- **DO NOT** dry clean this heated pad, for cleaning follow the instructions supplied.
- There are no user serviceable parts, the pad should only be repaired or serviced by a qualified service engineer.
- It is recommended this heated pad is used in conjunction with a residual current device (RCD) with a rated residual operating current not greater than 30mA.
- This pad is only for use by humans and shouldn't be used for pets.
- When in use the control unit must not be placed near open windows or inside the bed covers.
- Be sure the pad is only connected to an electrical supply as specified in the instructions.
- Switch off the power and remove the plug from the socket outlet when not in use.
- **It is recommended that this appliance should not be used whilst sleeping.**

Explanation of Symbols

The following warning symbols or words are used in this instruction manual:



Products labelled with this symbol conform to applicable provisions of the European Economic Area.



Products labelled with UK Conformity Assessment identifies products conforming to UK statutory requirements.



This symbol indicates that the heater is double insulated and therefore does not require an Earth connection.

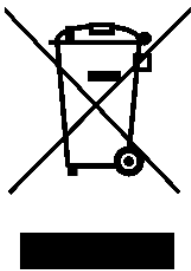

You should now recycle your waste electrical goods and in doing so help the environment. This symbol means waste electrical products at the end of their useful life should not be disposed of with normal household waste and not sent to landfill. Please ensure it is taken to a suitable facility for disposal. Check with your Local Authority or retailer for recycling advice or visit www.recycle-more.co.uk enter your postcode to find out your nearest recycling site.



This symbol provides useful additional information on the use of this product.



This symbol indicates that the supply uses an alternating current mains supply.



This designates a hazard with moderate risk, which may result in severe injury if not adhered to.

Before the first use of Your Heated Pad

Remove all packing materials and discard responsibly.

Description of Parts

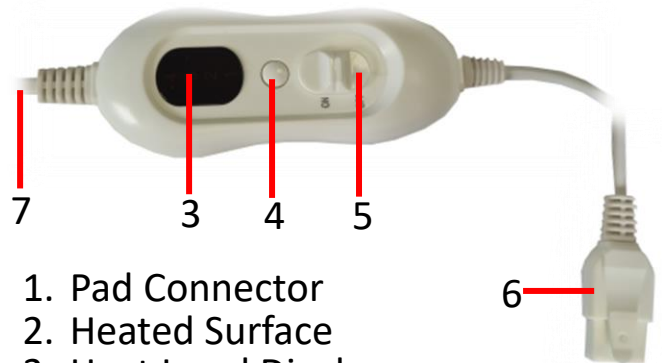

1. Pad Connector
2. Heated Surface
3. Heat Level Display
4. Heat Select Button
5. ON/OFF Switch
6. Controller Connector
7. Mains Lead
8. Fixing Straps

Using Your Heated Pad

1. Make sure Mains Plug is not inserted into the socket.

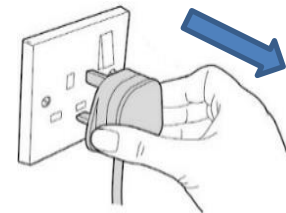
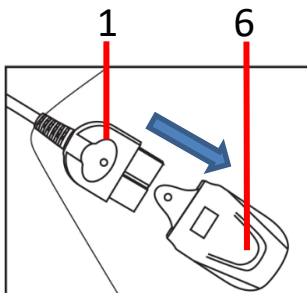

2. Plug the **Pad Connector** (6) into the **Controller Connector** (1) and insert the mains plug into a socket.

3. Move the **On/Off Switch** (5) to 'ON' position



4. Press **Heat Select Button** (4) to select the desired heat level from **1** to **4** as shown on the **Heat Level Display** (3). The heat levels are shown right:

- 1 = Low
 2 = Moderate
 3 = Medium
 4 = High

i During the first few minutes of initial use, you may notice a slight odour. This is normal and will quickly disappear, It is the coating applied to the heating elements to prevent any corrosion during transit.

i This Heated Pad should never be used whilst folded or rucked as this will cause overheating and the operation of the thermal safety device and stop the product working.

Detaching the Controller

Before removing ensure the **On/Off Switch** (5) is set to '0' (OFF) position and remove the mains plug from the wall socket.

Lift the locking tab up and pull the controller connector directly out as shown below.

Do not pull the controller cable or try and pull the controller connector out without lifting the locking tab as the socket may be damaged.

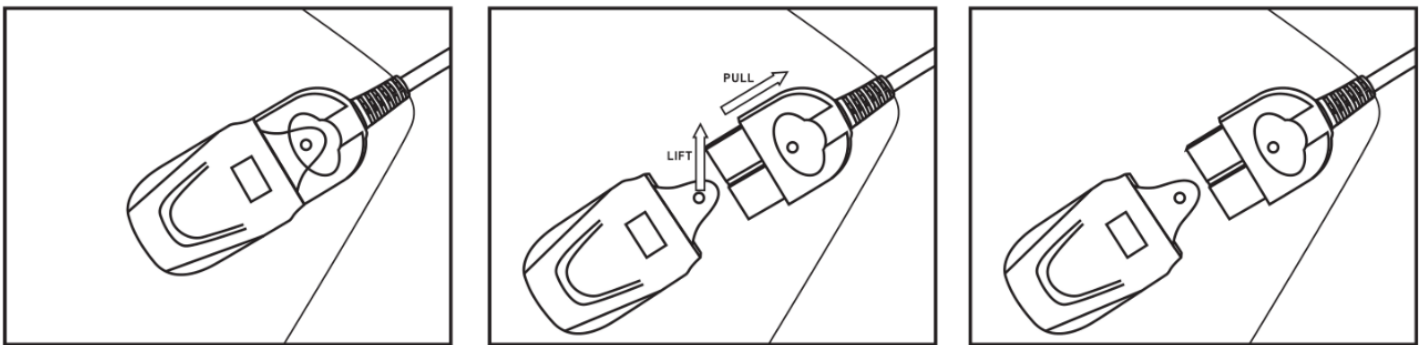

Care and Maintenance

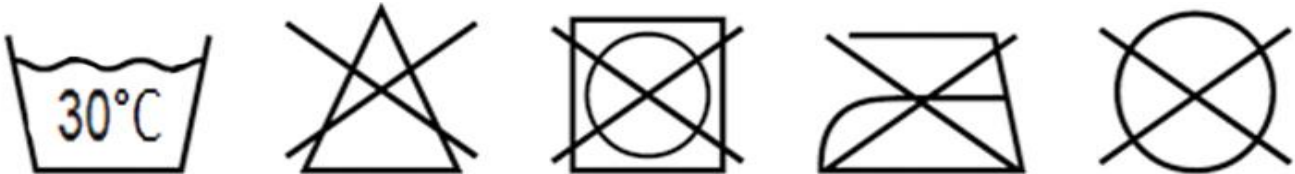

- Use only as a heated pad.
- Machine wash at 30°C.
- Do not iron.
- Do not dry clean.
- Do not bleach.
- Line dry.
- Do not use folded or rucked.
- Do not insert pins into heated pad.
- Do not use the heated pad if wet or moist.
- Do not use with a helpless person, an infant or a person insensitive to heat.
- Not to be used by very young children (0-3 years).



Spot cleaning

Sponge the affected area using a lukewarm neutral detergent or a mild soap solution. Follow this by sponging using clean water. Remove any excess water by compressing the wet area between absorbent towels.

Washing the Heated Pad

⚠ WARNING!

- **BEFORE WASHING, DISCONNECT THE CONTROLLER FROM THE HEATED PAD AS DESCRIBED ABOVE.**
- **DO NOT ALLOW THE CONTROLLER, ITS MAINS CABLE OR PLUG TO COME INTO CONTACT WITH WATER OR ANY OTHER LIQUIDS.**

Hand Washing

Immerse the heated pad only in a lukewarm neutral detergent or soap solution. Soak for five minutes then remove from the solution and gently squeeze the solution through the pad, rinse in clean water.

After washing, lay the pad flat or drape the pad over a clothesline to dry, **DO NOT** use clothes pegs to secure it to the line.

DO NOT wring the pad.

Machine Washing

Disconnect the controller and place the pad in a net bag and seal it. Use a small amount of detergent and set the washing machine to a “Delicate Wash” with a maximum temperature of 30°.

After washing, lay the pad flat or drape the pad over a clothesline to dry, **DO NOT** use clothes pegs to secure it to the line.

DO NOT wring the pad.

Technical Specification

Rated Voltage	220V-240V AC ~ 50Hz
Rated Power	85W
Model Number	HEA1839GE
Protection Class	II

Non-Rewireable Mains Plug

If your appliance is supplied with a non-rewireable plug fitted to the mains lead and should the fuse need replacing, you must use an ASTA approved one (conforming to BS 1362 of the same rating). Never use a plug with the fuse cover missing, if in doubt, consult a qualified electrician.

If you need to remove the plug – **DISCONNECT FROM THE MAINS** – and then cut it off the mains lead and immediately dispose of it safely. Never attempt to reuse the plug or insert it into a socket outlet as there is a danger of electric shock.

Recycling Information

Disposal of the Packaging

Dispose of paper and cardboard in appropriate paper re-cycling facilities.

Dispose of recyclable plastics in appropriate plastic re-cycling facilities.

Dispose of non-recyclable plastics in the appropriate plastics collection service.

Disposal of the Product

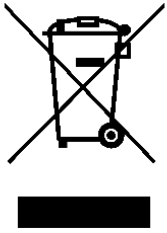

You should now recycle your waste electrical goods and in doing so help the environment. This symbol means waste electrical products at the end of their useful life should not be disposed of with normal household waste and not sent to landfill. Please ensure it is taken to a suitable facility for disposal. Check with your Local Authority or retailer for recycling advice or visit www.recycle-more.co.uk, enter your postcode to find out your nearest recycling site.

Customer Support

Should you require any product information, replacement parts or accessories, please contact our customer care team at help@daewooelectricals.com or call 0161 831 7879.

- *Replacement parts and accessories are guaranteed for 1 year from the date of purchase.*
- *It is important to note that your warranty becomes invalid should non Daewoo parts or accessories be used with this appliance*

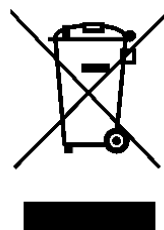
**UK
CA**



DAEWOO®

WARRANTY

Thank you for purchasing your Daewoo product.

As part of our commitment to quality, we are offering you an extra 2 years warranty in addition to your 1 year guarantee

Your Daewoo product is guaranteed for 1 year from the date of original purchase, with proof of purchase or receipt. If any defect should occur due to faulty workmanship or material, your faulty product should be returned to the place of purchase, replacement or refund is at the discretion of the retailer.

The guarantee is subject to the following provisions:

- The product must be correctly installed and operated in accordance with the requirements contained in the instruction manual.
- The product must be used solely for domestic purposes.
- It does not cover general wear and tear, damage, misuse or any consumable parts.
- The guarantee will be rendered invalid if the product is re-sold or has been damaged through inexpert repair.
- The guarantee is only valid within the UK and Eire.

Your standard 1 year guarantee will only be extended to the maximum available for your individual product upon registration. (Note: products must be registered individually and covers the main body and housing). If you do not register your product within 28 days of the original purchase date, your product will only be guaranteed for 1 year.

To validate your extended 2 year warranty* please register your purchase online within 28 days of the original purchase date by registering at:

<https://help.daewooelectricals.com>

or

[Contact Us \(daewooelectricals.com\)](https://daewooelectricals.com)

****Your extended warranty is only valid with proof of purchase receipt and subject to the conditions outlined above.***

Daewoo is a registered trademark.
Produced and imported under license by
Eurosonic Group Limited
Brightgate House
1 Brightgate Way
Manchester M32 0TB UK

EU Rep: EuroSonic Magppie (ESM) Ltd. Ireland D05 X006
www.esgltd.com