



DAEWOO®



*Please refer to the warranty section for terms of your extended guarantee



CYCLONE TURBO 3 IN 1 HANDHELD VACUUM CLEANER

WITH TURBO BRUSH

Contents

Page No.	
2	Contents
3	Reading and Storing the User Manual
3	Important Safety Instructions for Proper Use
6	Explanation of Symbols
7	Description of Parts & Accessories
8	Assembling Your Vacuum Cleaner
8	Before First Use of Your Vacuum Cleaner
9	Using Your Vacuum Cleaner
10	Setting the Brush Speed
10	Attaching the Tools to Your Vacuum Cleaner
12	Emptying and Cleaning Your Vacuum Cleaner
13	Removing, Cleaning and Refitting the Filter Assembly
16	Cleaning the Outlet Filter
17	Removing the Floor Brush for Cleaning
18	Replacing the Floor Brush
19	Care and Maintenance of Your Vacuum Cleaner
20	Recommended Filter Cleaning Intervals
21	Storing Your Vacuum Cleaner
21	Troubleshooting Guide
22	Technical Specification
22	Plug Wiring Information
22	Recycling Information
23	Customer Support
Back Page	Warranty Information

READING AND STORING THE USER MANUAL



Before using this product, please read through this manual carefully paying particular attention to the safety instructions. Failure to do so may result in personal injury or damage to the product.

Carefully save this instruction manual for future reference.

Ensure the user manual is included when passing the product on to any third parties.

IMPORTANT SAFETY INSTRUCTIONS FOR PROPER USE

When using electrical appliances, basic safety precautions should always be followed.

Only use the product as described in this user manual. Any other use is considered improper and may result in damage to property or persons.

The manufacturer or vendor cannot be held liable for damages or injury incurred through improper or incorrect use.

- **Read and familiarise yourself with all operating instructions before using this Vacuum Cleaner.**
- Before plugging your unit into the mains, visually check that the unit is intact and has not suffered any transit damage.
- Check that the voltage indicated on the data plate corresponds with that of the local network before connecting the appliance to the mains power supply.
- This appliance can be used by persons with reduced physical, sensory or mental capabilities or lack of experience and knowledge if they have been given supervision or instruction concerning use of the appliance in a safe way and understand the hazards involved.
- Children shall not play with the appliance.
- Keep the appliance and its cord out of reach of children less than 8 years when it is energised or cooling down.
- **DO NOT** immerse the appliance or its cord in water or any other liquids.
- **DO NOT** leave the appliance unattended during use.
- **DO NOT** leave the appliance unattended whilst connected

to the mains supply.

- **DO NOT** use this appliance outdoors.
- It is imperative to unplug the power cord after the appliance has been used, before it is cleaned and whilst being repaired.
- Repairs to electrical appliances should only be performed by a qualified electrician. Improper repairs may place user at serious risk.
- **DO NOT** operate this appliance with a damaged plug or cord, after a malfunction or after being dropped or damaged in any way.
- Regular, periodic checks should be carried out on the mains cable to
 - ensure no damage is evident. Should there be any signs of damage the appliance should not be used.
 - If the power cable is damaged, it should only be replaced by the manufacturer or a suitable qualified after-sales-service in order to avoid a hazard
- **DO NOT** allow the mains cable to hang over sharp edges or come in contact with hot surfaces.
- Allow the unit to cool before storage.
- Before cleaning, disconnect the appliance from the mains supply and allow to cool.
- This appliance is intended for household use only and should not be used for industrial purposes.
- **DO NOT** use any accessories or attachments with this appliance other than those supplied or recommended by supplier.
- **DO NOT** use this appliance for anything other than its intended use.
- **DO NOT** push objects into any openings as damage to the appliance and/or electric shock may occur.
- Unplug after each use. Grasp the plug, not the cord.
- **DO NOT** pull or carry the Vacuum Cleaner by the electrical cord, use the handle provided.

-
- Ensure fingers and other objects are never placed in any part of the vacuum cleaner. Clothing or hair may become trapped if the vacuum is used improperly.
 - Keep hair, loose clothing, jewellery, fingers and all parts of the body away from openings and moving parts.
 - Keep all air vents clear and free of dust, lint, hair and anything else that may reduce airflow.
 - Avoid directing the appliance towards naked flames as the air discharged may extinguish gas fires or pilot lights and may disturb ashes in open fires.
 - **DO NOT** Vacuum water or any other liquids with this vacuum.
 - **DO NOT** Vacuum hot ashes or lit cigarettes, etc.

Explanation of Symbols

The following warning symbols or words are used in this instruction manual:



Products labelled with UK Conformity Assessment identifies products conforming to UK statutory requirements.



Products labelled with this symbol conform to applicable provisions of the European Economic Area.

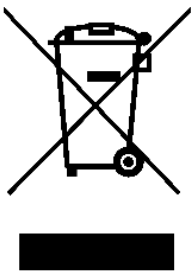

You should now recycle your waste electrical goods and in doing so help the environment. This symbol means waste electrical products at the end of their useful life should not be disposed of with normal household waste and not sent to landfill. Please ensure it is taken to a suitable facility for disposal. Check with your Local Authority or retailer for recycling advice or visit www.recycle-more.co.uk, enter your postcode to find out your nearest recycling site.



This symbol provides useful additional information on the use of this product.



This symbol indicates that the supply uses an alternating current mains supply.

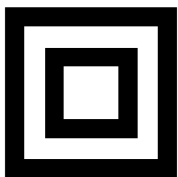

This symbol indicates that the product is double insulated and therefore does not require an earth connection.



This designates a hazard with moderate risk, which may result in severe injury or damage to the product if not adhered to.

Description of Parts & Accessories

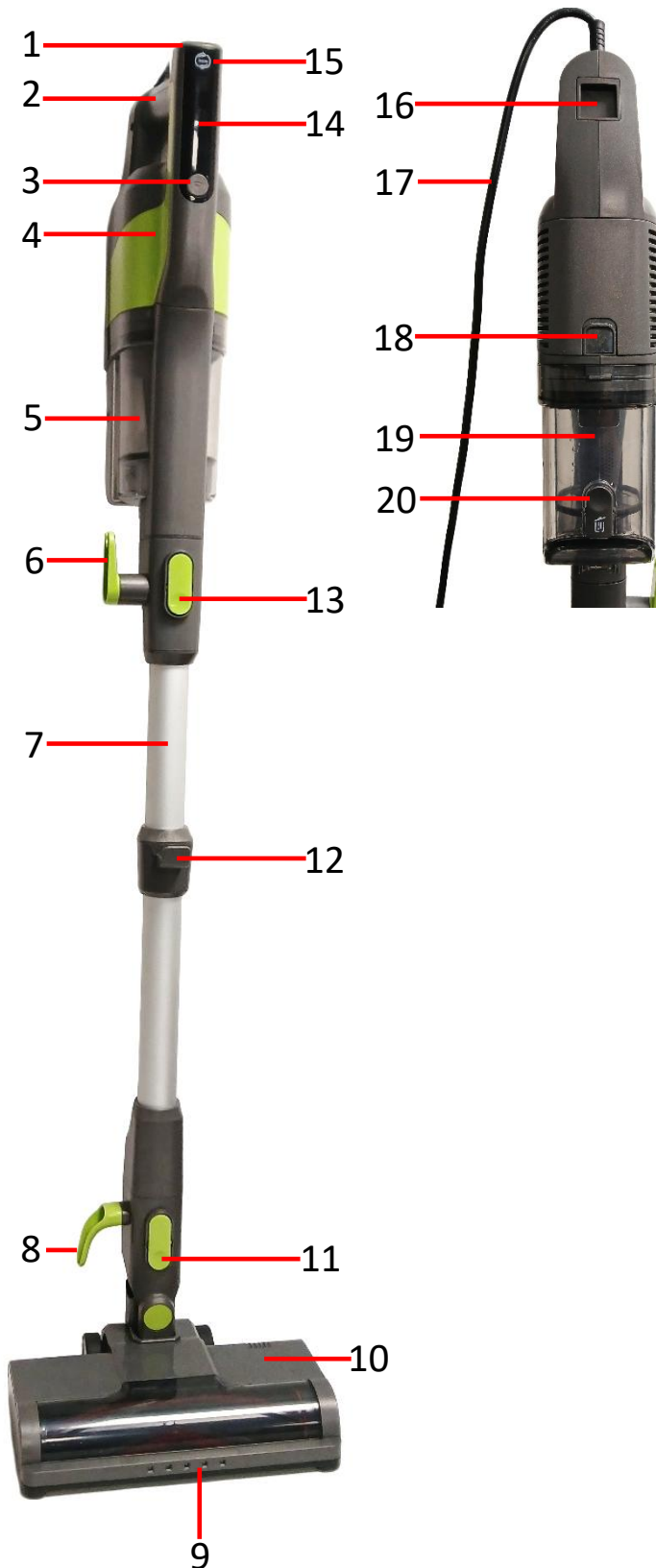

1. On/Off Button
2. Handle
3. Dust Compartment Release Button
4. Motor Unit
5. Dust Compartment
6. Upper Cable Hook
7. Aluminium Tube
8. Lower Cable Hook
9. Floor Lights
10. Motorised Floor Tool
11. Floor Tool Release Button
12. Storage Hook
13. Motor Unit Release Button
14. Mode Display
15. Mode Button
16. Storage Hook Recess
17. Mains Cable
18. Outlet Filter Cover Release Catch
19. Filter Assembly
20. Dust Release Catch

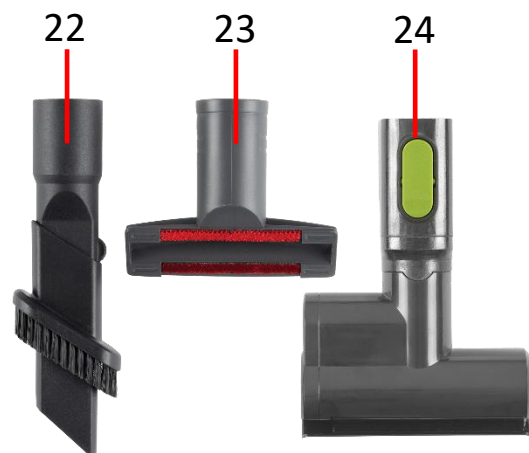

Assembling Your Vacuum Cleaner

Assemble your vacuum cleaner as shown below:

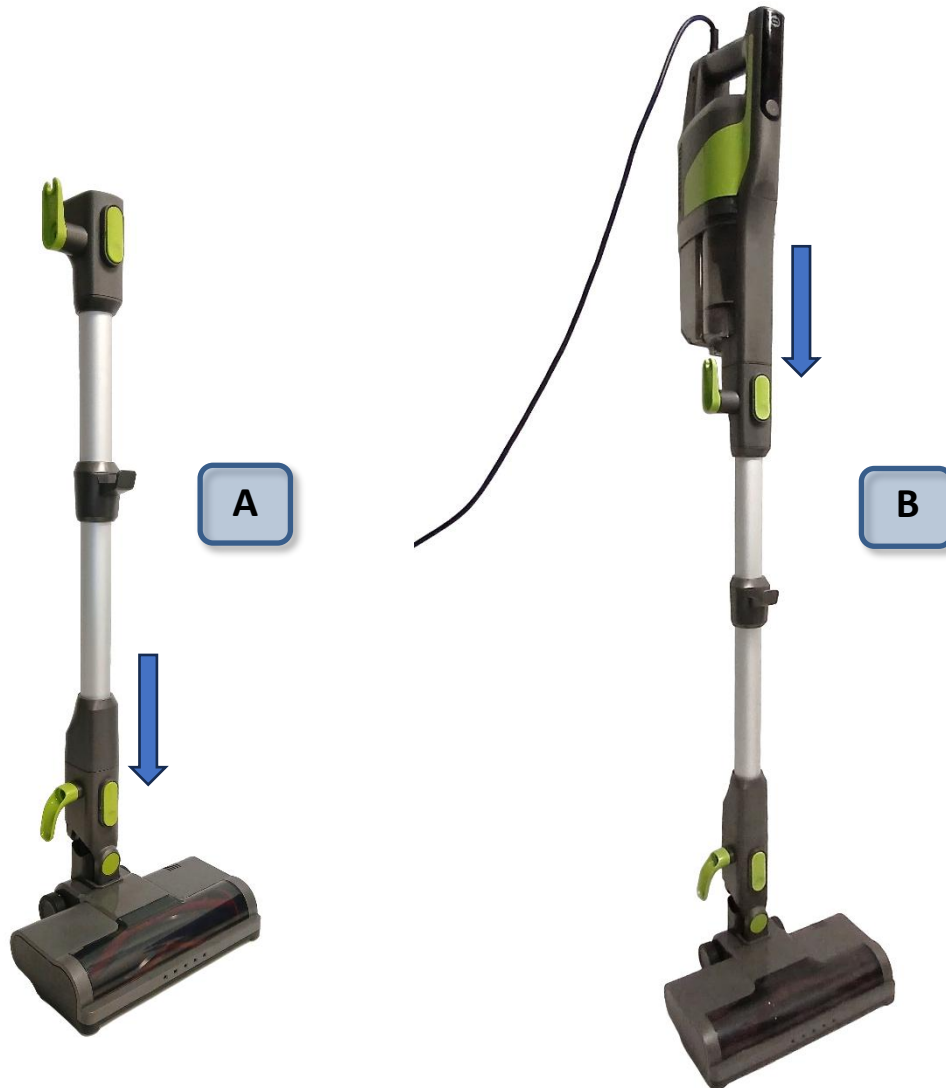

A. Insert the **Aluminium Tube** (7) into the **Motorised Floor Tool** (10) as shown in 'A' above.

B. Insert the **Motor Unit** (4) into the top of the **Aluminium Tube** (7) as shown in 'B' above.

C. Finally wrap the **Mains Cable** (17) around the **Upper** and **Lower Cable Hooks** (6 & 8).

NB the **Upper Cable Hook** (6) can be rotated downwards to help removal of the mains cable.

Before first use of Your Vacuum Cleaner

Remove all packing materials and discard responsibly.

Ensure that all parts are present – See **Description of Parts** above and that there is no damage to any component or the mains cable.

Using Your Vacuum Cleaner

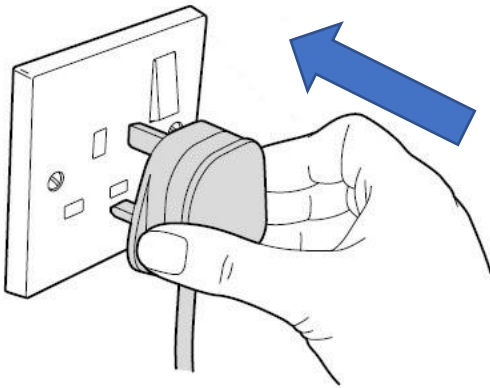
1

1. Once you have assembled your vacuum cleaner, fully unravel the **Mains Cable (17)** and insert the mains plug into the nearest socket.

2&3

2. Grip the vacuum by the **Handle (2)** and press the **On/Off Button (1)** at the top of the **Motor Unit (4)** to power up the vacuum. The **Floor Lights (9)** will also light up.

3. Place your foot gently on the **Motorised Floor Tool (10)** and pull the cleaner back by the **Handle (2)** and start vacuum cleaning.



Setting the Brush Speed

The brush speed of the **Motorised Floor Tool** (10) can be altered according to the type of floor being cleaned.

Press the **Mode Button** (15) to select from Carpet cleaning mode to Hard Floor cleaning mode as shown below:



Left: Press the **Mode Button** (15) to select the Carpet Mode, in this mode the Carpet symbol is illuminated.

Right: Press the **Mode Button** (15) to select the Hard Floor Mode, in this mode the Hard Floor symbol is illuminated. Use this to clean Vinyl, Laminates, Tiles, etc.



Attaching the Tools to Your Vacuum Cleaner



1. Attach the **Motorised Turbo Brush** (24) to the **Motor Unit** (4) to clean the Stair carpet as shown in the example left.

2

2. Attach the **Upholstery Tool (23)** to the **Motor Unit (4)** to clean Sofas, Chairs, Mattresses, Cushions, etc. as shown in the example right:

**3**

3. Attach the **Crevice Tool & Brush (22)** to the **Motor Unit (4)** to clean hard to reach areas, carpet edges, stairs, etc. as shown left:

**4**

4. Attach the **Crevice Tool & Brush (22)** to the **Motor Unit (4)** and pull the brush down to brush clean crevices such as the sides of a cushion on upholstery or carpet edges as shown right:



Emptying and Cleaning Your Vacuum Cleaner

⚠ WARNING! Always disconnect the cleaner from the mains power supply before cleaning.

1



1. Once the dust level reaches the 'MAX' mark (arrowed left) on the **Dust Compartment** (5) it will need to be emptied.

⚠ WARNING! **DO NOT** continue to use the vacuum cleaner once the 'MAX' mark has been reached as permanent damage may occur to the appliance and may also invalidate your warranty.

2. Hold the **Motor Unit** (4) over a waste bin. Press the **Dust Release Catch** (20) to allow the base of the **Dust Compartment** (5) to swing open and release the dust into the waste bin. As shown below:

2

i Once all the dust has been released, push the base of the **Dust Compartment** (5) closed.



Cleaning, Removing and Refitting the Filter Assembly (19)

1. Remove the **Motor Unit (4)** Press the **Dust Compartment Release Button (3 – arrowed below)** to separate the **Dust Compartment (5)** from the **Motor Unit (4)** as shown right:



2. **Left:** Support the **Dust Compartment (5)** as the **Dust Compartment Release Button (3)** is pressed to prevent it falling away from the **Motor Unit (4)**.

1. Remove the **Filter Assembly (19)** from the **Dust Compartment (5)** as follows:

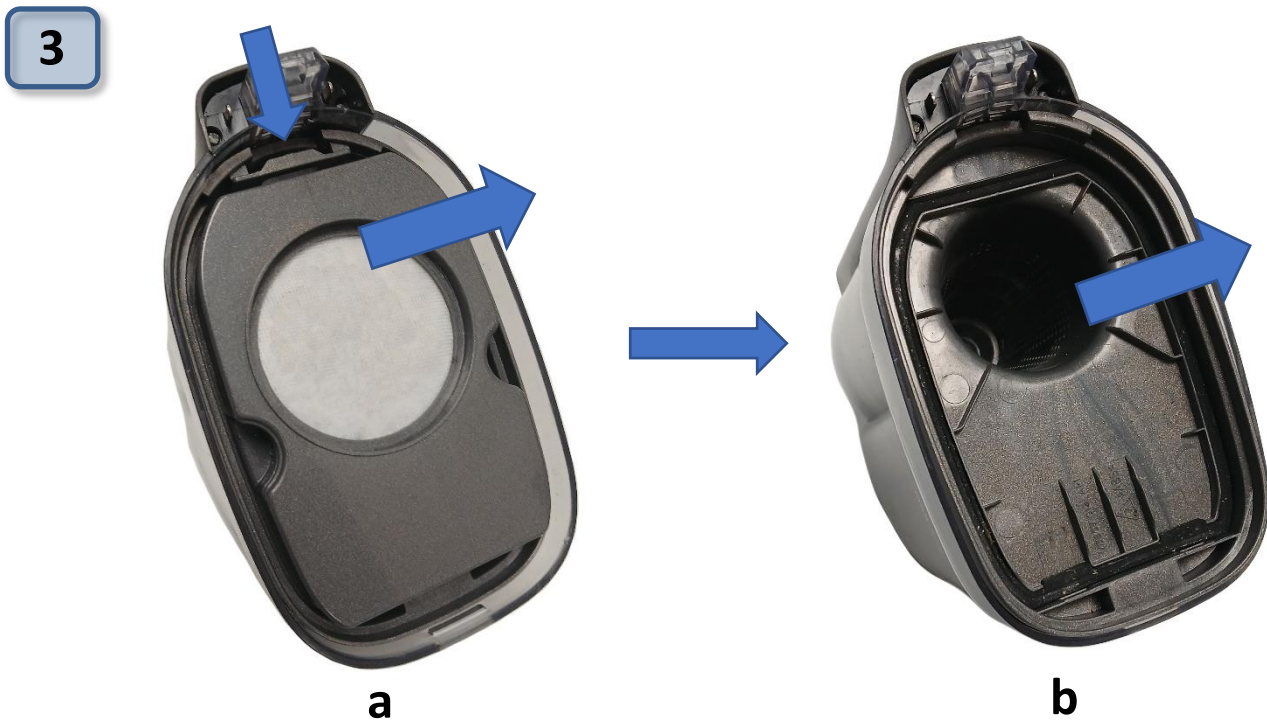

- a. Push the retaining catch inwards and lift out the Hepa and Sponge Filters together.
- b. Pull the Conical Filter out of the **Dust Compartment (5)**.

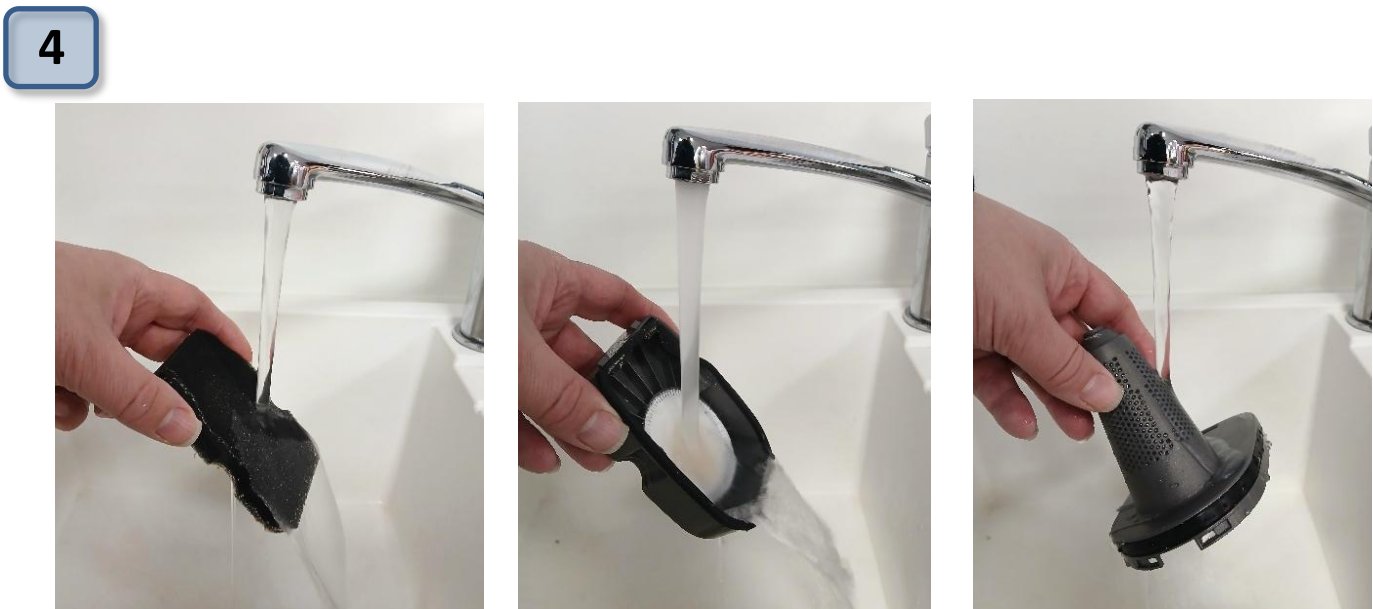

2. Wash the Sponge, Hepa Filter and Conical Filter in warm running water until clean. Allow the filters to dry thoroughly for 24 hours before reusing.

5



5a. Once dry, push the Sponge Filter into the Hepa Filter as shown left:



5b. Hook the Sponge and Hepa Filter unit onto the Conical Filter at the rear and then push down until it clicks into place.



5c. Replace the **Filter Assembly (19)** into the **Dust Compartment (5)**.

6. Reattach the **Dust Compartment (5)** to the **Motor Unit (4)** as shown right:

Hook the rear of the **Dust Compartment (5)** onto the **Motor Unit (4)**.

Push the two parts together until the release catch clicks home.



⚠ WARNING! DO NOT use your vacuum cleaner without the filters fitted as this will cause permanent damage to the cleaner and may invalidate your warranty.

Cleaning the Outlet Filter



1. Push the **Outlet Filter Cover Release Catch (18)** in the direction of the arrow and remove the cover as shown left:



Remove the Hepa outlet filter and wash in warm running water until clean. Allow the filter to dry thoroughly for 24 hours before replacing into the vacuum and replacing the filter cover.

Removing the Floor Brush for Cleaning

Remove the floor brush from the **Motorised Floor Tool (10)** using the guide below:

A

A. Push the retaining catch in the direction of the arrow on the underside of the **Motorised Floor Tool (10)** and remove the retaining clip.

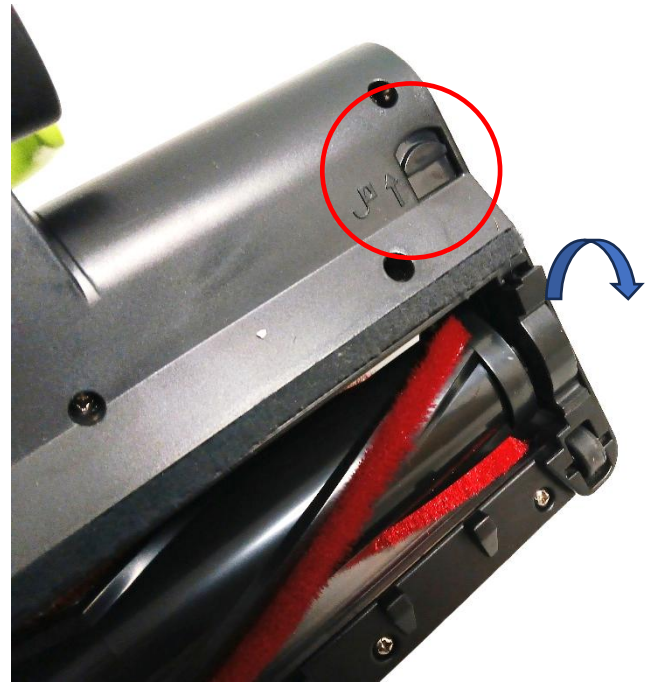

B

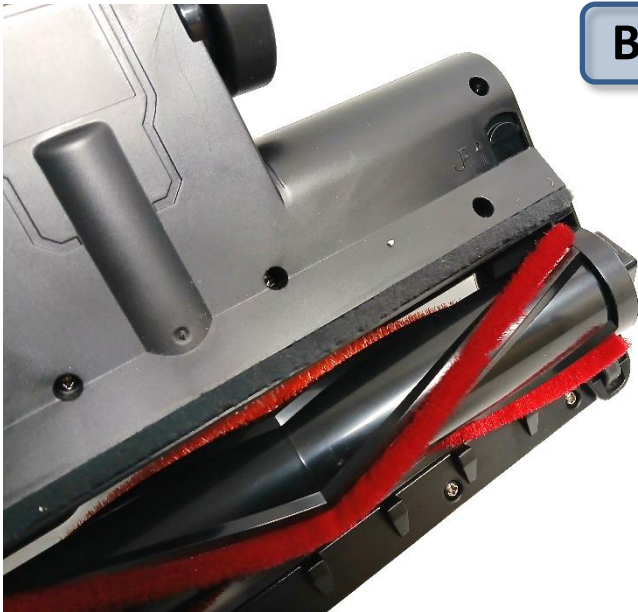

B. Remove the **Floor Brush (21)**.

C

C. Remove the floor brush from the **Motorised Floor Tool (10)** and clean by removing hairs and fluff, etc.

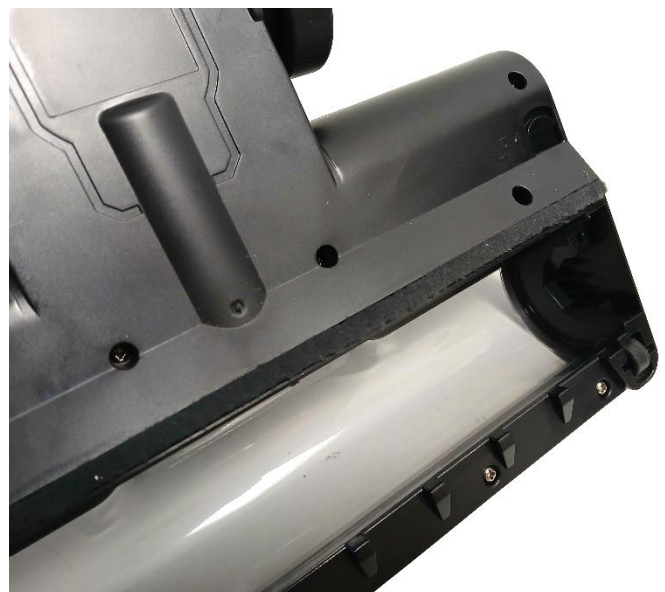

Replacing the Floor Brush

Follow the reverse of the above procedure to replace the **Floor Brush (21)**:



The **Floor Brush (21)** will require a little rotating back and forth before it locates onto the spindle and allows the brush to drop back in place as arrowed right.

B

Ensure the triangular lug (shown arrowed left) on the end of brush (21) is the correct way up as shown and fits into the triangular recess in the **Motorised Floortool (10)** shown arrowed right.



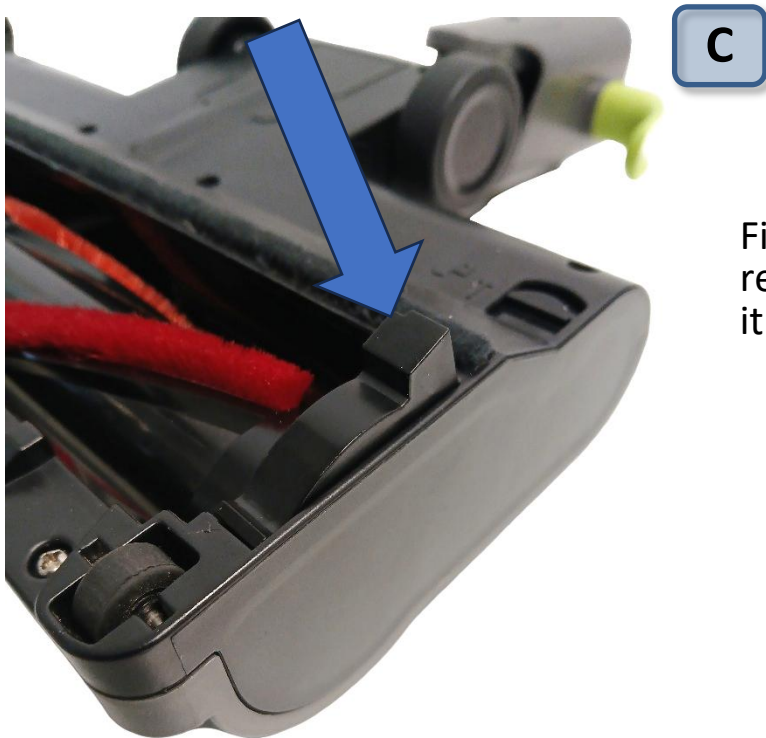

Finally, once the brush is in, replace the retaining clip and push it down until it clicks into place.

Care and Maintenance of Your Vacuum Cleaner

- Always disconnect the cleaner from the mains power supply before cleaning.
- Clean outside of the cleaner with a clean damp cloth. Never clean with harsh or abrasive cleaners.
- Do not submerge the cleaner or its mains cable in water or any other liquids.
- Empty the **Dust Compartment (5)** as soon as the 'MAX' mark has been reached.*
- Wash the **Filter Assembly (19)** regularly – see above and the table below.
- Allow the filters to thoroughly dry out for 24 hours before reassembly and use.

*  **WARNING!** **DO NOT** continue to use your vacuum cleaner once the 'MAX' mark has been reached as permanent damage may occur to the appliance which may invalidate your warranty.

Recommended Filter Cleaning Intervals

<i>Filter Type</i>	<i>Recommended Cleaning Period</i>
Hepa Filter 	<ul style="list-style-type: none"> • Shake out debris when you empty the dust container. • Rinse under warm water once a month. • Allow to dry thoroughly for 24 hours before reuse.
Conical Filter 	<ul style="list-style-type: none"> • Shake out debris once a month • Rinse under warm water once a month. • Allow to dry thoroughly for 24 hours before reuse.
Sponge Filter 	<ul style="list-style-type: none"> • Shake out debris when you empty the dust container. • Rinse under warm water once a month. • Allow to dry thoroughly for 24 hours before reuse.
Outlet Filter 	<ul style="list-style-type: none"> • Shake out debris once a month. • Rinse the Hepa filter under warm water once every 3-6 months. • Allow to dry thoroughly for 24 hours before reuse.

⚠ WARNING! Ensure the filters are cleaned periodically according to the table above, failure to clean the filters regularly will severely impair the performance and permanent damage may occur to the appliance which may invalidate your warranty.

Storing Your Vacuum Cleaner

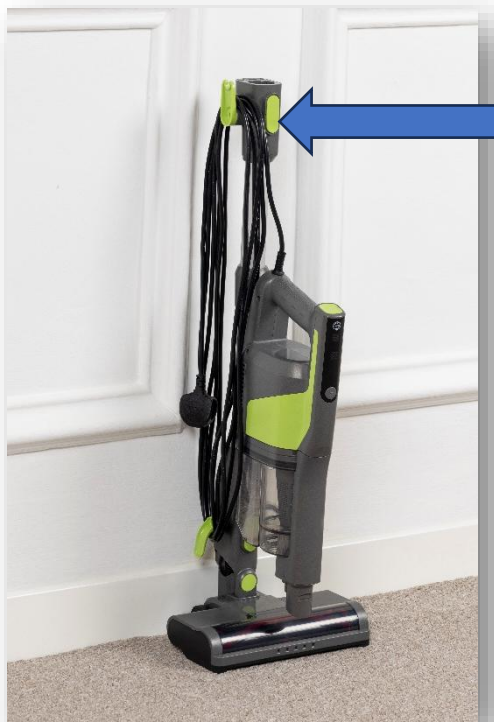

To store Your Vacuum when not in use, press the motor unit release catch (arrowed left) and lift the motor unit off from the **Aluminium Tube (7)**. Place the **Storage Hook (12)** on the **Aluminium Tube (7)** into the **Storage Hook Recess (16)** in the rear of the **Motor Unit (4)** so that the vacuum is shown in the image left.

Troubleshooting Guide

Problem	Possible Cause	Possible Solution
Unit fails to turn on.	The unit may not be properly plugged in.	Ensure the plug is fully inserted into the socket and the socket is switched on.
	The fuse in the plug may have blown	Check fuse by substitution.
	The fuse/circuit breaker may have tripped.	Check the fuse/circuit breaker on the mains board, if it has tripped, reset it.
	On/Off Switch has not been pressed.	Press the On/Off Switch.
Low suction or poor pick-up.	Dust Compartment is full.	Empty the Dust Compartment.
	Filters are clogged.	Check and clean the filters.
The vacuum is making a "hissing" sound.	The airflow is restricted	Empty the Dust Compartment. Check and clean the filters. Check and clear any blockages if necessary.

Technical Specification

Model Number	FLR00198
Supply Voltage	AC 220-240V ~ 50-60Hz
Rated Power	500W (max.)
Protection Class	II
IP Class	IPX0
Unpacked Weight	4.6 Kgs (approx.)
Filtration (Dust Compartment)	Hepa & Cyclonic Filter
Filtration (Outlet)	Hepa
Dimensions	22.0cm (d) x 25.1cm (w) x 127.5cm (h) (approx.)
Vacuum	>14kpa
Max Air Flow	13L/S
Noise Level	≤80dBA (approx.)
Dust Compartment Capacity	0.88L

Non-Rewireable Mains Plug

If your appliance is supplied with a non-rewireable plug fitted to the mains lead and should the fuse need replacing, you must use an ASTA approved one (conforming to BS 1362 of the same rating). Never use a plug with the fuse cover missing. If in doubt, consult a qualified electrician.

If you need to remove the plug – DISCONNECT FROM THE MAINS – and then cut it off the mains lead and immediately dispose of it safely. Never attempt to reuse the plug or insert it into a socket outlet as there is a danger of electric shock.

Recycling Information

Disposal of the Packaging

Dispose of paper and cardboard in appropriate paper re-cycling facilities.

Dispose of recyclable plastics in appropriate plastic re-cycling facilities.

Dispose of non-recyclable plastics in the appropriate plastics collection service.

Disposal of the Product

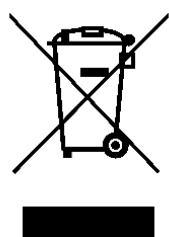

You should now recycle your waste electrical goods and in doing so help the environment. This symbol means waste electrical products at the end of their useful life should not be disposed of with normal household waste and not sent to landfill. Please ensure it is taken to a suitable facility for disposal. Check with your Local Authority or retailer for recycling advice or visit www.recycle-more.co.uk, enter your postcode to find out your nearest recycling site.

Customer Support

Should you require any product information, replacement parts or accessories, please contact our customer care team on 0161 831 7879 (8.30am-4.30pm Monday to Thursday, 8.00am-4.00pm Friday) and select option 3 or by contacting us via email: help@daewooelectricals.com.

- Replacement parts and accessories are guaranteed for 1 year from the date of purchase.
- It is important to note that your warranty becomes invalid should non Daewoo parts or accessories be used with this appliance.

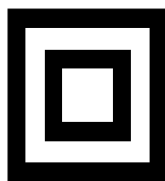
**UK
CA**



DAEWOO®

WARRANTY

Thank you for purchasing your Daewoo Vacuum.

As part of our commitment to quality, we are offering you an extra 2 years warranty in addition to your 1 year guarantee

Your Daewoo vacuum product is guaranteed for 1 year from the date of original purchase, with proof of purchase or receipt. If any defect should occur due to faulty workmanship or material, your faulty vacuum should be returned to the place of purchase, replacement or refund is at the discretion of the retailer.

The guarantee is subject to the following provisions:

- The product must be correctly installed and operated in accordance with the requirements contained in the instruction manual.
- The product must be used solely for domestic purposes.
- It does not cover general wear and tear, damage, misuse or any consumable parts.
- The guarantee will be rendered invalid if the product is re-sold or has been damaged through inexpert repair.
- The guarantee is only valid within the UK and Eire.

Your standard 1 year guarantee will only be extended to the maximum available for your individual product upon registration. (Note: products must be registered individually and covers the main body and housing). If you do not register your product within 28 days of the original purchase date, your product will only be guaranteed for 1 year.

To validate your extended 2 year warranty* please register your purchase online within 28 days of the original purchase date by registering at:

<https://help.daewooelectricals.com>

or

[Contact Us \(daewooelectricals.com\)](https://help.daewooelectricals.com)

*Your extended warranty is only valid with proof of purchase receipt and subject to the conditions outlined above.

Daewoo is a registered trademark.
Produced and imported under licence by
Eurosonic Group Limited
Brightgate House
1 Brightgate Way
Manchester M32 0TB UK
EU Rep: EuroSonic Magppie (ESM) Ltd. Ireland D05 X006
www.esgltd.com